

Double acting

Spring return

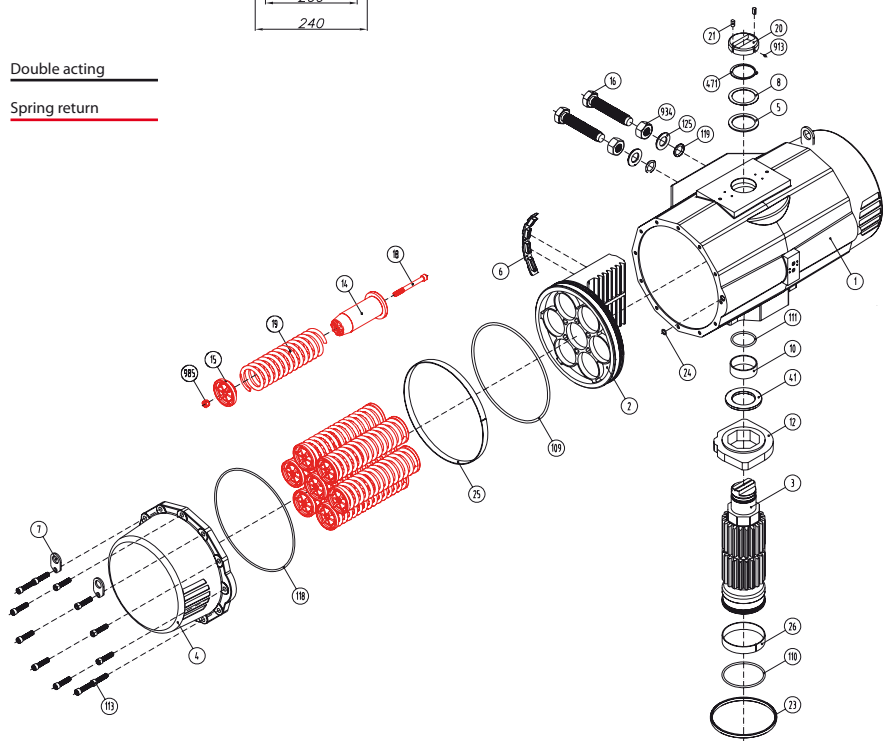

Dimensions\*

A	A'	B	C	D	E	F	I	R	ØS	ISO	ØL	M x V	ISO	ØL'	M' x V'	ØT	X	U
940	630	434	415	213	201	16	15	55	72,5	F16	165	M20x30	F25	254	M16x30	200	4	60

Max. pressure	Rotation	Screw stroke adjustment	Chamber Ø (mm)	Air volume (L)		Stroke Time (Sec. (A))		Operating Temperature (°C)		
				Opening	Closing	Opening	Closing	STD (std.)	HT (high temp.)	LT (low temp.)
8 bar	90° ± 5°	for 1° need 1/3 turn	340	33,2	27,5	D 3,0	D 3,5	NBR O-ring	FPM O-ring	Silicone O-ring

Double acting actuator „DA“ torque output in [Nm]

Typ	3 bar		3,5 bar		4 bar		4,5 bar		5 bar		5,5 bar		6 bar <sup>2</sup>		6,5 bar		7 bar		8 bar		Kg
	0°	90°	0°	90°	0°	90°	0°	90°	0°	90°	0°	90°	0°	90°	0°	90°	0°	90°	0°	90°	
D	2408	2809	2809	3210	3612	4013	4414	1846	5217	5618	6421	129,4									

Spring return actuator „SR“ torque output in [Nm]

Typ	3 bar		3,5 bar		4 bar		4,5 bar		5 bar		5,5 bar		6 bar (A)		6,5 bar		7 bar		8 bar		Spring stroke		Kg		
	0°	90°	0°	90°	0°	90°	0°	90°	0°	90°	0°	90°	0°	90°	0°	90°	0°	90°	0°	90°	End	Start			
S06	1763	1262	2165	1663	2566	2065	2967	2466	3369	2867	3770	3269											758	1348	158,7
S08	1549	880	1950	1282	2351	1683	2752	2084	3154	2485	3555	2887	3956	3288	4358	3689	4759	4091	5068	4399	1011	1797	164,7		
S10					2136	1301	2538	1702	2939	2104	3340	2505	3742	2906	4143	3307	4544	3709	4853	4017	1264	2246	170,8		
S12							2323	1320	2724	1722	3125	2123	3527	2524	3928	2926	4329	3327	4638	3636	1516	2696	176,9		
S14 <sup>2</sup>											2911	1741	3312	2142	3713	2544	4115	2945	4423	3254	1769	3145	182,9		

<sup>2</sup>Standard construction

Materials

1	<b>Body</b>	Aluminium hard anodized
2	<b>Piston</b>	Aluminium
3	<b>Pinion</b>	Nickel plated carbon steel
4	<b>End caps</b>	Aluminium epoxy coated
5	<b>Soft piston washer</b>	Polyamide PA 6,6
6	<b>Slide piston</b>	Polyamide PA 6,6 + 30% G.F.
8	<b>Pinion washer</b>	Stainless steel
10	<b>Upper pinion bearing</b>	Hostalen RCH 1000
12	<b>Stop</b>	ASTMA 105
14	<b>(*) Springs long support</b>	Polyamide PA 6,6
15	<b>(*) Springs short support</b>	Polyamide PA 6,6
16	<b>Leveling screw</b>	Stainless steel
18	<b>(*) Bolt</b>	Stainless steel
19	<b>(*) Spring</b>	DIN 2076 - D-5,6
20	<b>Position indicator</b>	Polyamide
21	<b>Cam</b>	Polyamide
23	<b>Centering ring</b>	Nickel plated carbon steel
24	<b>Plug air stop</b>	NBR
25	<b>Slide guide</b>	Polyamide PA 6,6 + 30% G.F.
26	<b>Lower pinion bearing</b>	Hostalen RCH 1000
109	<b>O-ring</b>	NBR
110	<b>O-ring</b>	NBR
111	<b>O-ring</b>	NRB
113	<b>Bolt</b>	Stainless steel
118	<b>O-ring</b>	NBR
119	<b>O-ring</b>	NBR
125	<b>Washer</b>	Stainless steel
913	<b>Set screw</b>	Stainless steel
471	<b>External circlip</b>	Stainless steel
934	<b>Nut</b>	Stainless steel
985	<b>(*) Nut</b>	Stainless steel

(\*) Only for serie SR

General characteristics

<b>Mounting of solenoid valves</b>	Namur Std.	
<b>Mounting of devices</b>	Namur V DI	Namur V DE 3845 Std.
<b>Coupling according</b>	ISO 5211	DIN 3337
<b>Marking</b>	CE	Ex II 2 GdC LCIE 05 AR 022
<b>Test and certificates</b>		
<b>Quality assurance</b>	ISO 9001	

SR4000 / DA4000

copyright © by  
FERGO® Armaturen GmbH

Mainstrasse 26-30  
D41469 Neuss

Tel.: +49(0) 2137 - 9 30 80-0  
Fax: +49(0) 2137 - 9 30 80-99

Web: www.fergo.biz  
E-Mail: info@fergo.biz

**fergo**